

Paperfox MPE-2 Electric paper punch

**Operational manual
26-nov-2020-en**



Important notice!

If the machine stopped and you can't release the cutting depth setting screw with hand, do not try to release it with any tool. Read the "Troubleshooting" for the solution. Devices made after 2020 have a button for reverse operation. With this button you can release the stopped machine. If it don't helps you can follow the "Troubleshooting" for the solution.

Warning

- a) The machine may be utilized only in a closed room (office, shop).
- b) Prior to the machine utilization, definitely read all instructions.
- c) To reduce the risk of injury, an inspection shall be essential, if the product utilized in the vicinity of children.

Parameters

Dimensions: (L x W x H)	40x26x110 cm
Nett weight:	26,5 kg
Packaged dimensions: (L x W x H)	42x28x114cm
Brutto weight:	28,5kg
Supply voltage:	230V/50Hz
Power:	370W
Fuses:	2 x 3.15A, 100mA
Operating temperature:	+5...+40 °C
Storage temperature:	-25...+55 °C (+70 °C max. 24 hours)
Noise output:	less than 70 dB(A)
Max operating altitude:	1500m (from the sea surface)
Manufacturer:	Paperfox H-2142 Nagytarcsa, Tessedik S. u. 48.

Safety parts

Name:	Manufacturer:	Type:	Data:
Transformer			230/18V 1,8VA
Safety switch	Schneider	SCHNxB5AS542	
Main switch	Schneider	SCHNxB5AW84B5	ON + OFF + 24V LED
Fuse		100mA	
Fuse (2pcs)		3.15A	
Motor	Lammers	7JB71B4 0,37 kW.B14 230	0,37kW, single phase, 1450 1/min.

Safety instructions

- The Paperfox MPE-2 electric paper punch is designed only for punching paper, cardboard, leather, corrugated paper, foil or other soft sheet materials. Do not try to punch steel, thick aluminium, hard and plastic or other hard materials.
- Please read the operating instructions before you use MPE-2 Electric Paper Punch to prevent accidents and ensure the trouble-free operation.
- The MPE-2 Electric Paper Punch Machine may not be operated by anyone who does not read or does not fully understand the operating manual.
- The MPE-2 Electric Paper Punch may not be used in wet or explosive environment.
- Always use a proper lighting.
- To ensure the easy unplugging use a socket in a height 0,6 and 1,9m.
- Always use a proper socket with a safety ground.
- Never change the fuse to any other type as the designated value.
- Before beginning the reparation or changing the fuses make sure that the MPE-2 Electric Paper Punch is disconnected.
- Repairs should be carried out by qualified persons using original spare parts, otherwise this may result in considerable danger for the user.
- Do not remove the safety coverage and do not disconnect the safety electronic from the machine.
- Keep the MPE-2 Electric Paper Punch and the environment clean and tidy.
- Keep enough space around the MPE-2 Electric Paper Punch
- Do not wear loose clothing or jewellery, they can be caught in parts.

Transportation of Paperfox MPE-2 Electric Paper Punch

- Keep the MPE-2 Electric Paper Punch in the corrugated paper box to avoid damage.
- Two people should unpack the machine. One should keep the box, the other should pull the MPE-2 out of the package.
- To avoid the damage of the cord, wrap it up and fix it to the machine during transportation.

Parts of the PaperfoxMPE-2 Paper punch

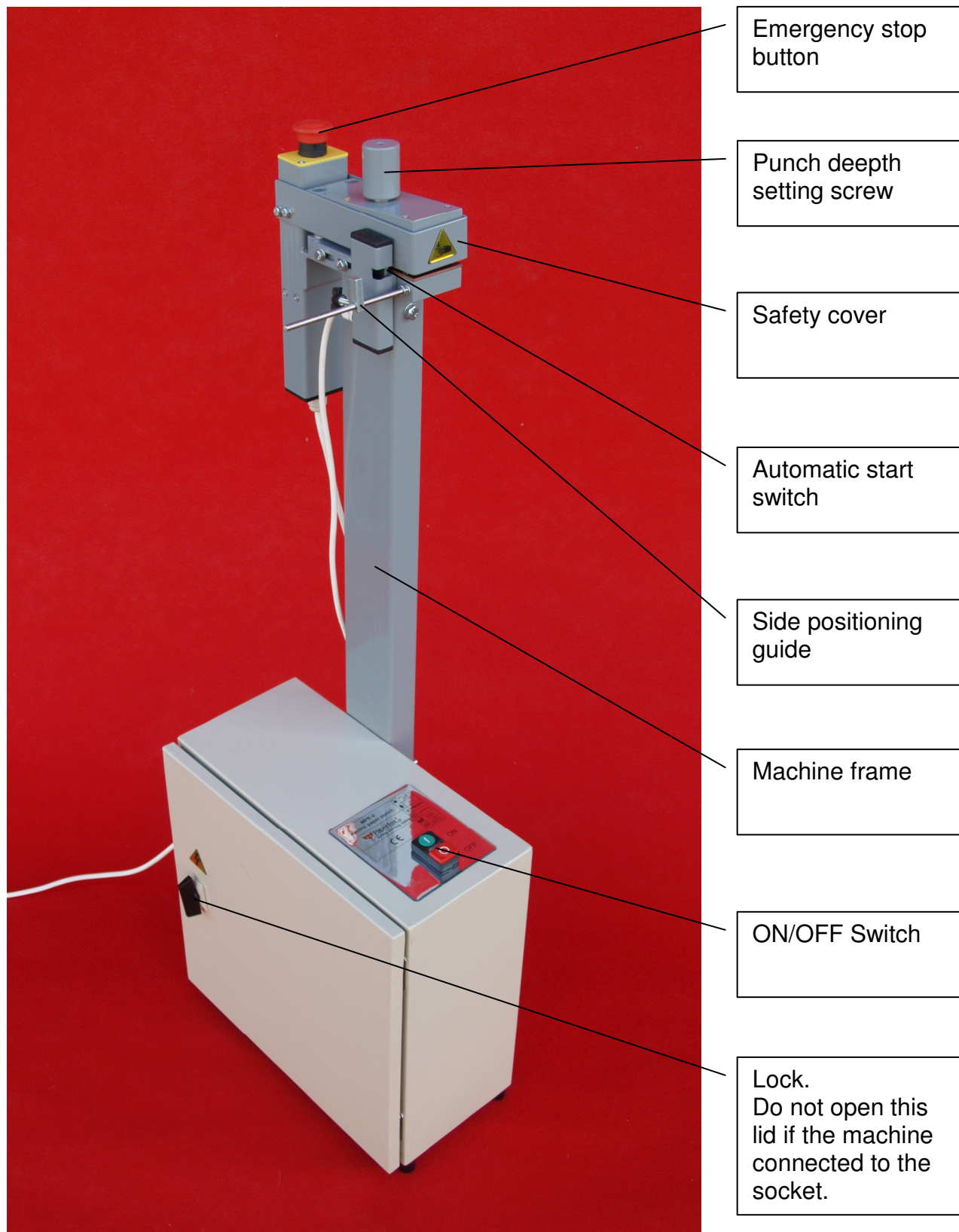

Buttons on machines made after 2020

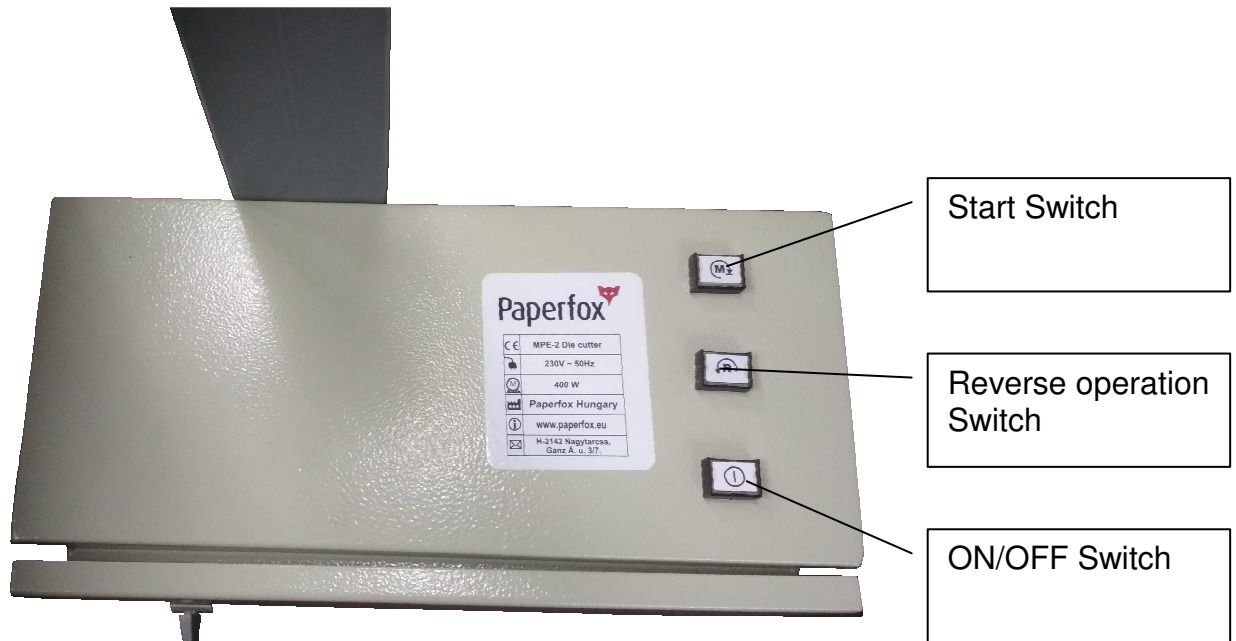

You can switch on/off the device by pressing the ON/OFF Switch.

With pressing the Start Switch you can start a punching cycle. The effect of this button is the same as the foot switch (if it is connected) or the Automatic Start Switch.

In case of overload the machine can get stuck. In this case you can use the Reverse operation button to release the stucked machine.

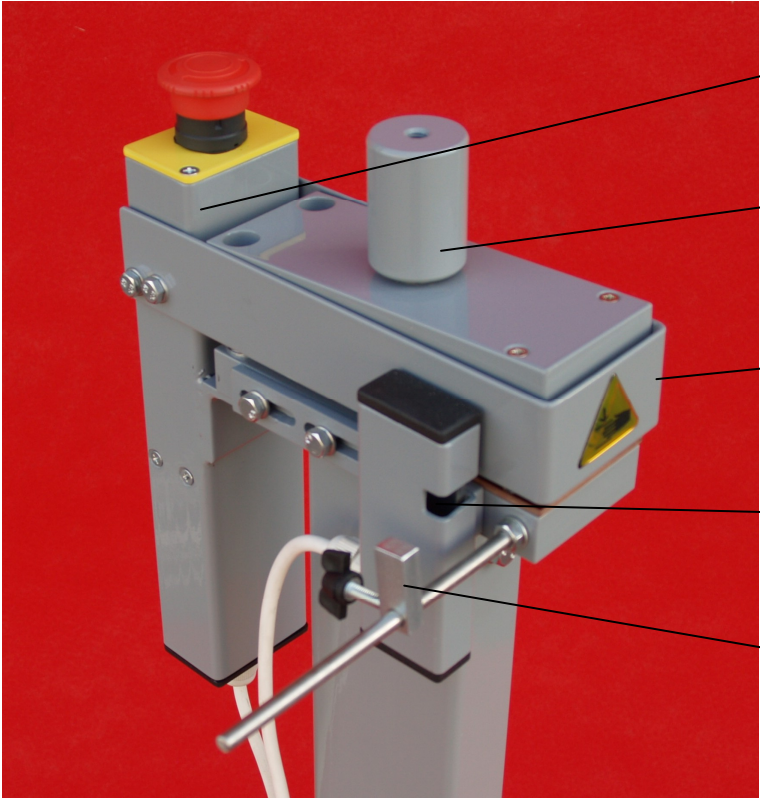

Safety cover
switch

Cutting deepth
setting screw

Safety cover

Automatic start
switch

Side positioning
guide

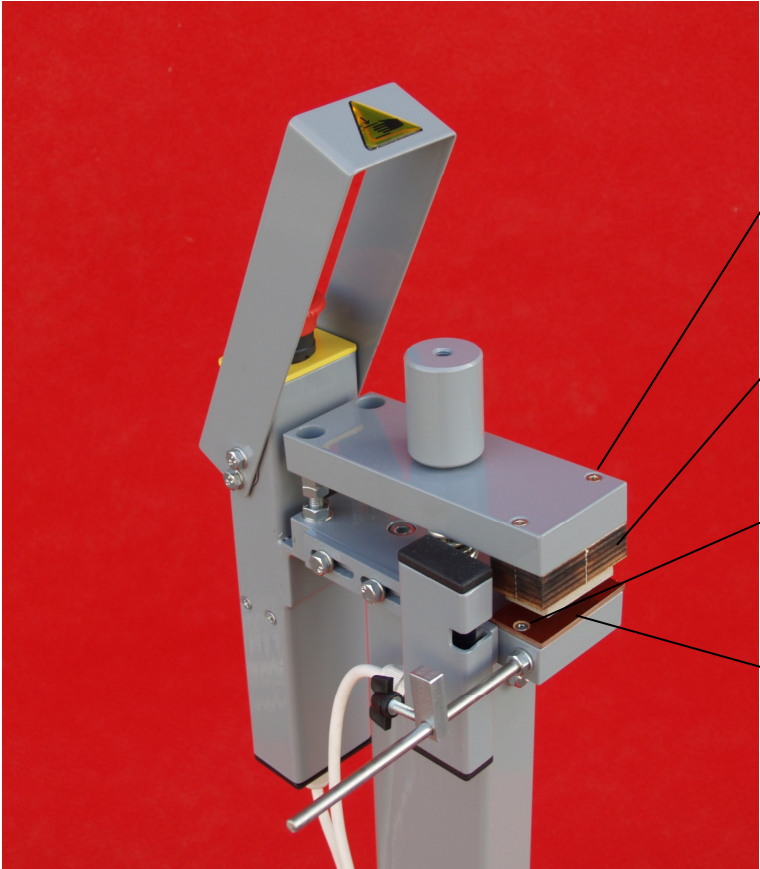

Punching tool
fixing screws

Punhing tool

Cutting plate
fixing screws

Cutting plate

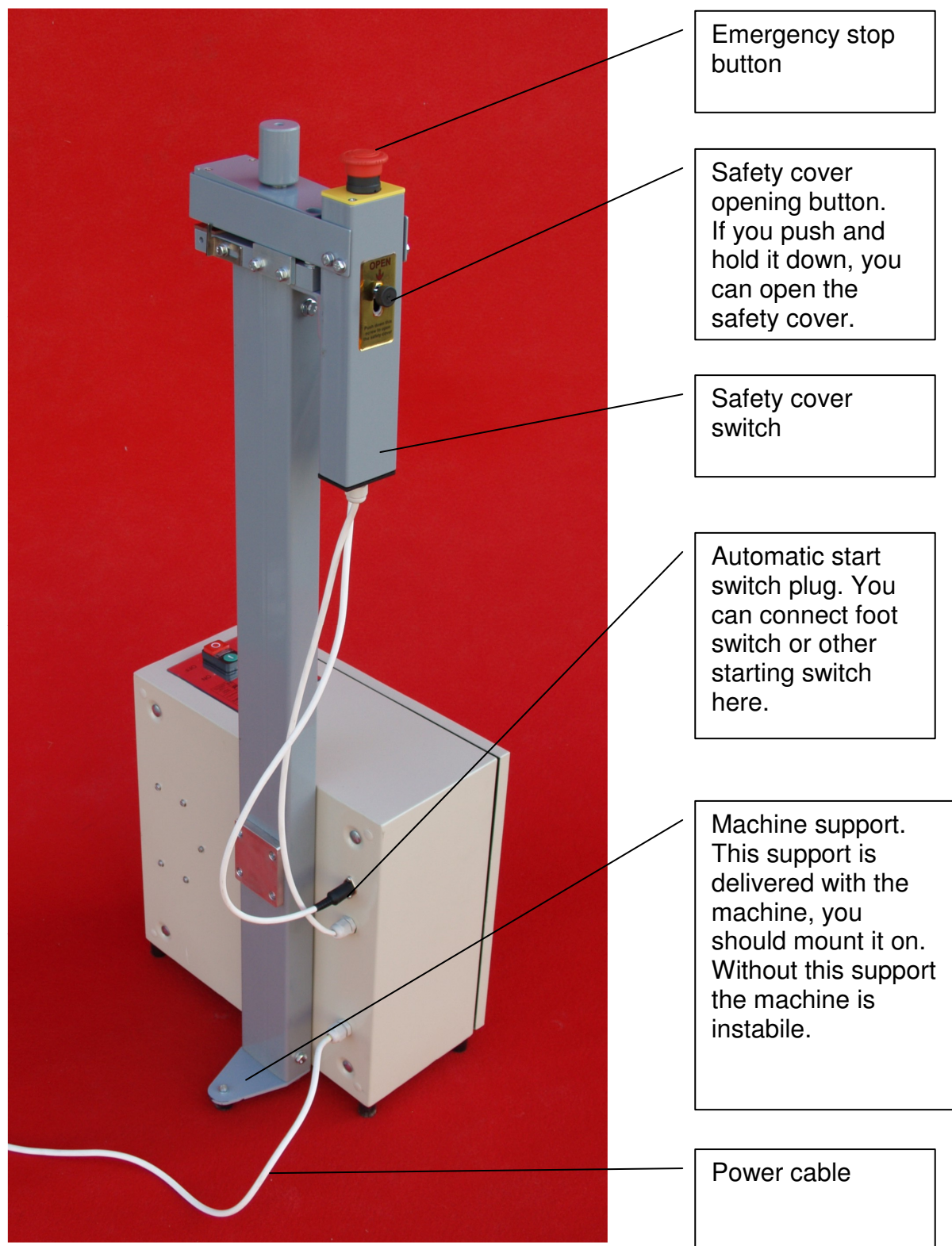

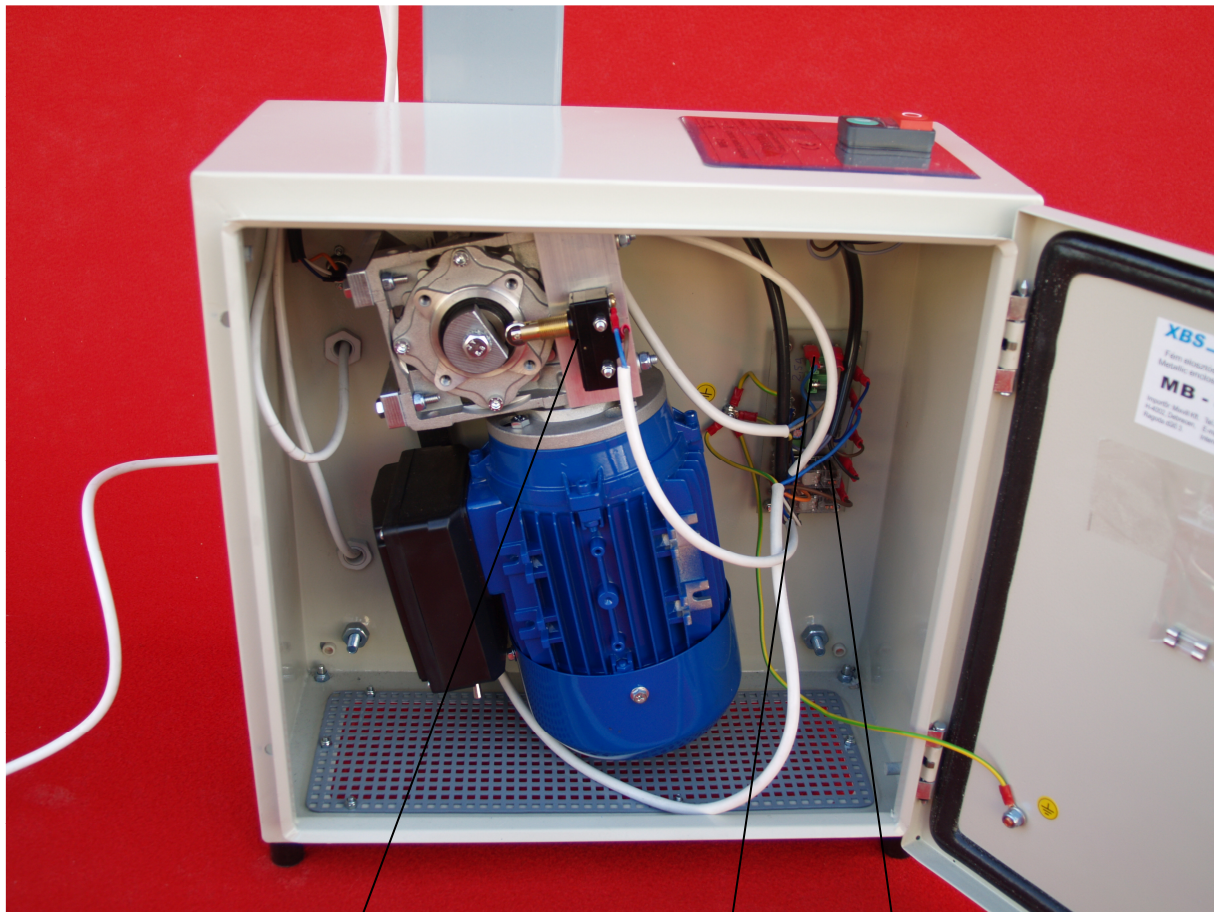

Excenter switch

Fuse. 2x3,15A

Fuse 100mA

Initial operation

- Before further use of the MPE-2 check it carefully, especially the safety cover, and the tape cable. Do not use the MPE-2 with damaged cord.
- Check the socket before connecting the MPE-2.
- Connect the MPE-2 to a socket. (230V~ 50Hz)
- Press the on switch, it have to light on.
- If the light not lights on, the If the light not lights on, check the safety cover. It should be closed.
- Perform a test punching. Insert a piece of paper into the machine, so that it should activate the automatic start switch. The machine should punch the paper properly.

Troubleshooting

Trouble:	Solution:
The power cable is damaged.	Do not use the MPE-2 with a damaged power cable. The damaged power cable should be changed by a qualified service person.
The safety cover is damaged or missing.	Do not use the MPE-2 with a damaged safety cover or without safety cover.
After plugging the plug of the MPE-2 into a socket and pressing the ON button, the light at the ON/OFF switch not lights.	Check if the emergency stop button is pushed down. You can set this button back with turning it as it is signed with the arrows.
	Check if the safety cover open. You can't switch on the machine with opened safety cover.
	Check that the plug of the MPE-2 is connected to a proper socket.
	Check the fuses. Warning! You should always remove the plug from the socket if you open the electric box of the machine!
The machine is switched on, the main switch lights, but after inserting a sheet of paper into the machine, the machine doesn't starts.	Check if the paper really activated the automatic start switch.
	Check if the cable of the automatic start switch is plugged into the MPE-2
The machine stopped with closed punching tool, and don't starts again. After replacing the fuse the new fuse burns out.	Maybe that the machine get stacked. Try to lose the cutting depth setting screw and start the machine. If you can't lose the cutting depth setting screw, then you can lose the mother of the parallelism setting screws, Turn the parallelism setting M8 imbus screws so that they get into a lowest possible position releasing the stacked punch depth setting screw. Release the cutting depth setting screw and set the parallelism as it is described in this manual.
The MPE-2 doesn't punch the paper well.	You can increase the cutting depth and the cutting force with the cutting depth setting screw.
	The cutting tool or the cutting plate is damaged. Replace them.
	If only some part of the sheet is not cutted well then you can try to set the parallelism.
The life time of the cutting plate and the tool is too short.	Reduce the cutting depth with the cutting depth setting screw. Use the minimal pressure which can punch the sheet well.

Opening the safety cover



Push downwards this screw and hold it down. Now you can tilt up the safety over.

While the safety cover is open, you can't switch on the machine. After closing the safety cover you can switch on the machine.

This cover is an important safety part of the Paperfox MPE-2 electric paper punch. You can open the safety cover after pressing and holding the safety cover opening screw down. When the safety cover is open you can't switch on the machine.

Changing the punching tool

There are several kind of tools are available for MPE-2 and also custom made tools can be used in the machine. You can order a tool from a local die maker. You can mount a 60x30mm steel rule die into the machine with two screws.

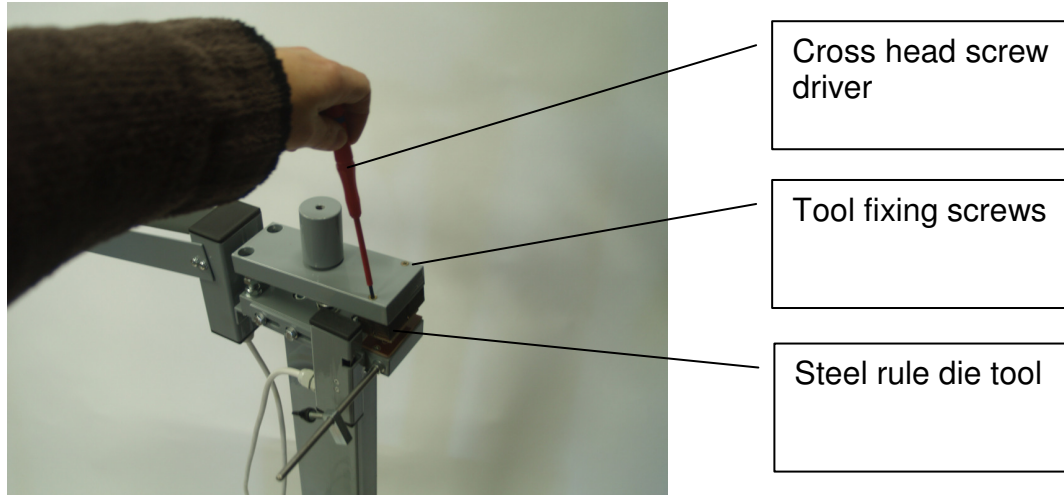

Changing the cutting plate

The cutting plate is subject to wear. You can turn it to the other side but you have to change it after certain time. Use original Paperfox VMP-1 cutting plates.

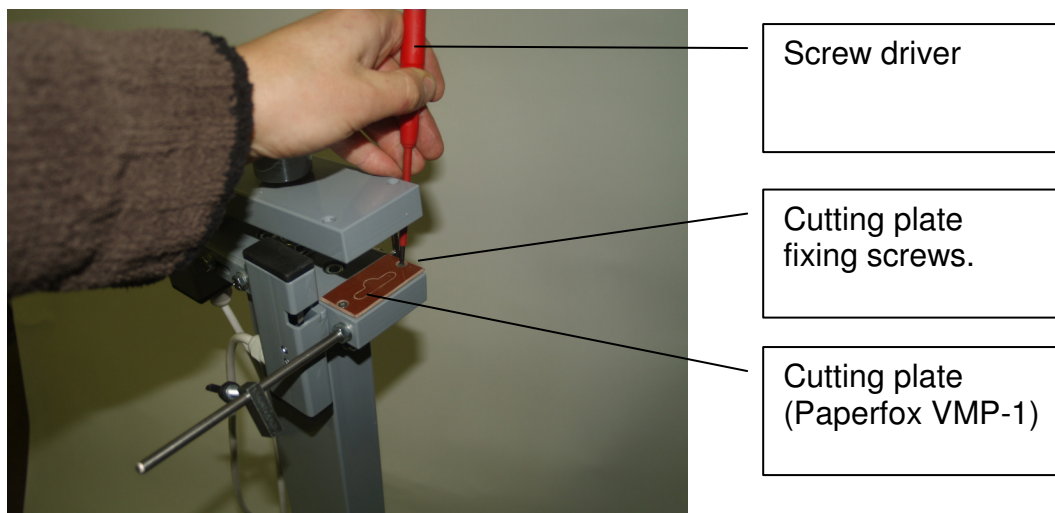

Setting the paper guides

You can set the desired position of the punching with the help of the paper guides. You can set the back position with a back paper guide and the automatic start switch also acts as a back paper guide. If you use a foot switch or other starting switch instead of the automatic start switch, then you can use two (left-right) back guides which are delivered with the machine.

You can mount the side guide to any side of the MPE-2.
You can set the side position with the side guide.

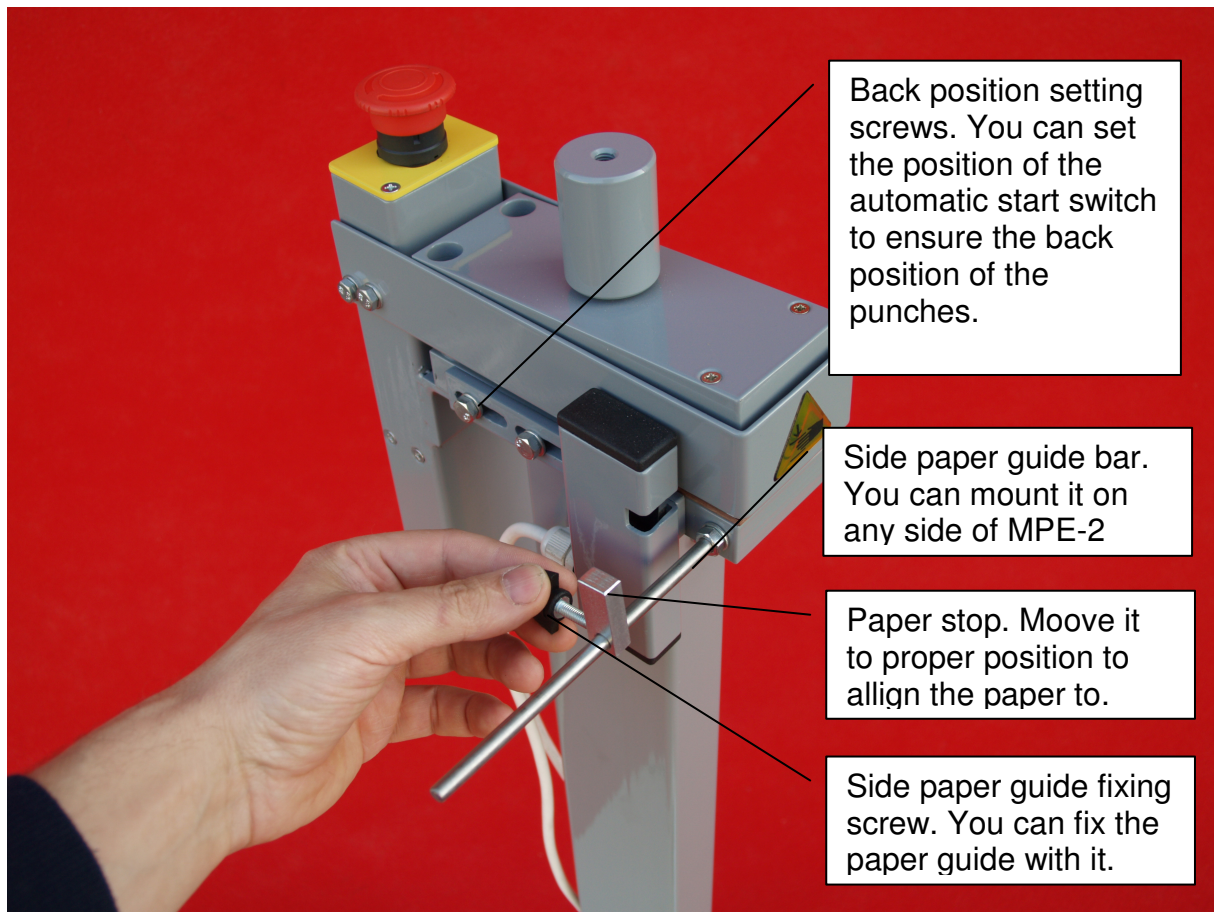

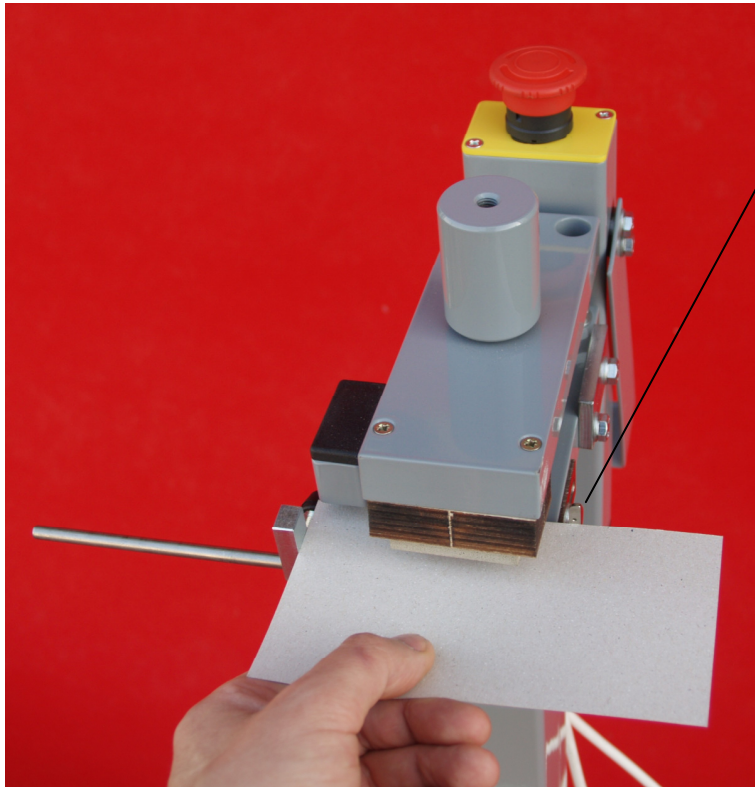

Back positioning paper guide at the other side of MPE-2. You can set the distance of punchings from the back edge of paper with this guide. You can set similar guide to the other side of MPE-2 too, if you remove the automatic start switch and use a foot switch. (extra accessory)

Setting the parallelism of the cutting tool to the cutting plate

After changing the tool or after certain usage maybe necessary to set the parallelism of the cutting tool and the cutting plate. If these parts are not parallel, then the tool doesn't cut every part of the paper properly.

- Do not use a damaged or overused tool or cutting plate when setting the parallelism.
- Set the minimal cutting depth and check which part of the form not cutted well.
- If a left or right side of the form not cutted well, then turn the M8 parallelism setting screw in this side clockwise. (You should release the M8 mother before)
- If the back side of the form is not cutted well then turn booth the M8 parallelism setting screws clockwise.
- If the front side of the form is not cutted well then turn booth the M8 parallelism setting screws counter clockwise.
- Set the parallelism in small steps with a lot of trial to the proper position. Be careful; do not overload the tool or the machine.
- After setting the parallelism, fix the M8 parallelism setting screws with the mothers and set the cutting depth so that the pressure to the minimum which can cut the form properly.

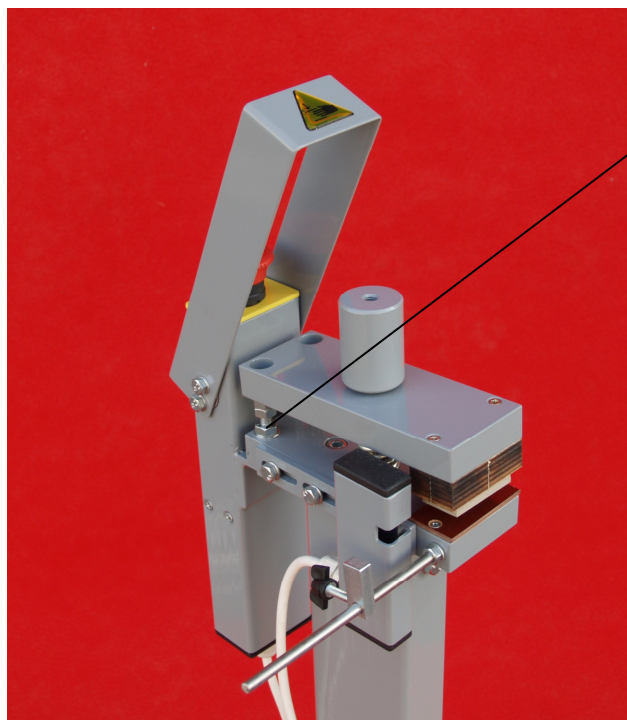

You can set the parallelizm of the MPE-2 with this two screws. You can set the M8 screws with a 6mm hexagon tool, and you can fix it with fastening the nut with a 13mm wrench.

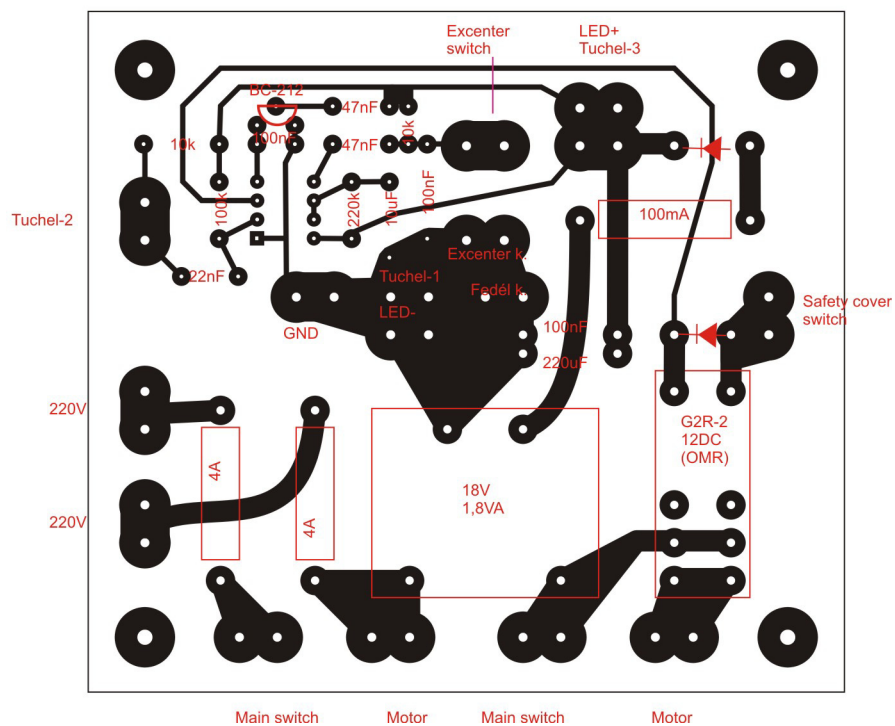



Declaration of conformity

We the manufacturer

Fürcht Zoltán ev.
H-1211 Budapest,
Táncsics Mihály u. 65.
www.paperfox.eu
+36 30 948-2491

Declare that the product

Kind of product: Electric paper punch
Type of product: Paperfox MPE-2

Is in compliance with the essential requirements and other relevant provisions of the following directives:

EMC Directive	2004/108/EC
Low voltage directive	2006/95/EC

The product is compatible with the following standards:

EN 60204-1 Safety of machinery. Electrical equipment of machines
EN 1088 Interlocking devices associated with guards
MSZ EN ISO 12100:2011 Safety of machinery

Budapest 21.12.2011

Fürcht Zoltán
1211 Budapest, Táncsics M. u. 65.
Telefon: 06-30-948-2491
Adószám: 41052059-2-43
Váll.lg.sz.: ES-232624

Fürcht Zoltán